

**NOTIONAL PARKING LAYOUT
WHEN USED FOR OVERFLOW PARKING**

- 1** NEW PETANQUE TERRAIN
- 2** INDOOR TENNIS CENTRE AND PARKING MODS.
- 3** FIELD SPORTS PAVILION
- 4** NEW CRICKET NETS
- 5** NEW BOWLS PAVILION
- 6** MAIN CLUBHOUSE AND SQUASH DEVELOPMENT

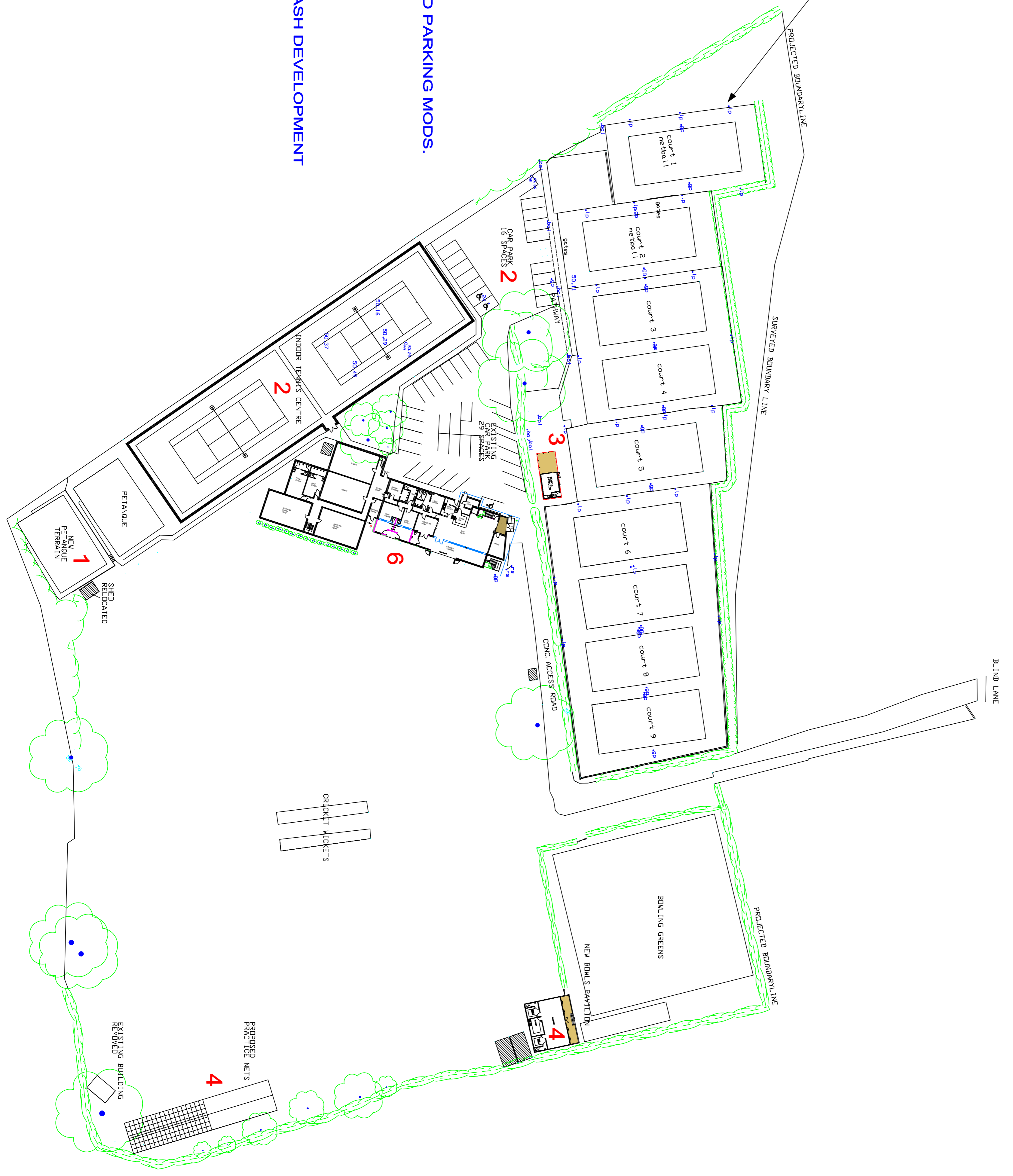

NOTE
 1 Under no circumstances should scaled dimensions be used for setting out
 2 This drawing is copyright and shall not be reproduced without permission
 3 This drawing is copyright and shall not be reproduced without permission

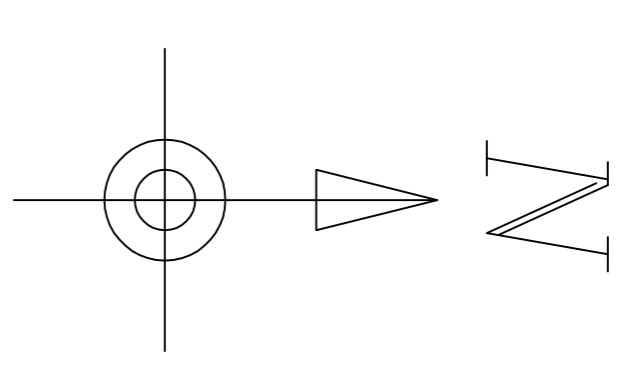

APPROXIMATE DIRECTION

1

PROPOSED SITE PLAN
OXSHOTT VILLAGE SPORTS CLUB

CLIENT	OXSHOTT VILLAGE SC
DRAWING NO	MD-258-1
SCALE	1:500
DATE	NOVEMBER 2011
DRAWN BY	DS
PROJECT	PROPOSED SITE PLAN

MACDONALD DESIGN LTD
 9 YOKNAGE CLOSE, LINDSEY WOOD SURVEYS
 KINGSLEIGH, KINGSLEIGH, KINGSLEIGH
 TEL: 01757 833987 FAX: 01757 832401
 steve@macdonald-design.com

This drawing is the copyright of Macdonald Design Ltd and shall not be reproduced without the written consent of Macdonald Design Ltd. All dimensions on this drawing check all dimensions on site.